

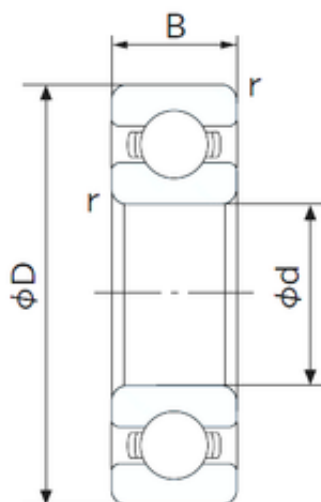

UIN BEARING CORP.



SKF Timken NSK NTN Koyo NACHI THK
 Snr Hiwin Deep Groove Ball Bearing Tapered
 Roller Bearing Spherical Roller Bearingwheel Hub
 Bearing 6201 6203 6205 6203z

Bearing No. 6201

6201 Bearing 2D drawings and 3D CAD models

| | |
|-------------------------------|--------------------------|
| Size | 12x32x10 mm |
| Bore Diameter | 12 mm |
| Outer Diameter | 32 mm |
| Width | 10 mm |
| d | 12 mm |
| D | 32 mm |
| B | 10 mm |
| C | 10 mm |
| r min. | 0.6 mm |
| da min. | 17 mm |
| Da max. | 27 mm |
| ra max. | 0.6 mm |
| Weight | 0.037 Kg |
| Basic dynamic load rating (C) | 6,8 kN |
| Basic static load rating (C0) | 3,05 kN |
| (Grease) Lubrication Speed | 22000 r/min |
| Category | Single Row Ball Bearings |
| Inventory | 0.0 |
| Manufacturer Name | NACHI |
| Minimum Buy Quantity | N/A |
| Weight / Kilogram | 0 |
| Product Group | B00308 |
| Enclosure | Open |



UIN BEARING CORP.

| | |
|---------------------------------|---|
| Precision Class | ABEC 1 ISO P0 |
| Maximum Capacity / Filling Slot | No |
| Rolling Element | Ball Bearing |
| Snap Ring | No |
| Internal Special Features | No |
| Cage Material | Steel |
| Internal Clearance | C0-Medium |
| Inch - Metric | Metric |
| Long Description | 12MM Bore; 32MM Outside Diameter; 10MM Outer Race Width; Open; Ball Bearing; ABEC 1 ISO P0; No Filling Slot; No Snap Ring; No Internal Special Features; C0-Medium Internal Clearance; Steel Cage |
| Other Features | Deep Groove |
| Category | Single Row Ball Bearing |
| UNSPSC | 31171504 |
| Harmonized Tariff Code | 8482.10.50.68 |
| Noun | Bearing |
| Keyword String | Ball |
| Manufacturer URL | http://www.nachiamerica.com |
| Weight / LBS | 0.081 |
| Bore | 0.472 Inch 12 Millimeter |
| Outside Diameter | 1.26 Inch 32 Millimeter |
| Outer Race Width | 0.394 Inch 10 Millimeter |
| Inner Race Width | 0 Inch 0 Millimeter |
| Bore Type | Cylindrical Bore |
| Configuration | Single Row |
| Bore Size | 12 mm |
| Width | 10 mm |
| | |



UIN BEARING CORP.

| | |
|-------------------------|-------------------|
| Fillet Radius/Chamfer | 0.6 mm |
| Dynamic Load Rating | 6,800 N |
| Static Load Rating | 3,050 N |
| Limiting Speed - Grease | 22,000 rpm |
| Limiting Speed - Oil | 28,000 rpm |
| Factor fo | 12.3 |
| Radial Clearance | 0.003 to 0.018 mm |
| da (min) | 17 mm |
| Da (max) | 27 mm |
| ra (max) | 0.6 mm |